

LUMIÈRE CONFIGURATION - D

LUMIÈRE DISPLAY - SETUP INSTRUCTIONS

Connecting Wall

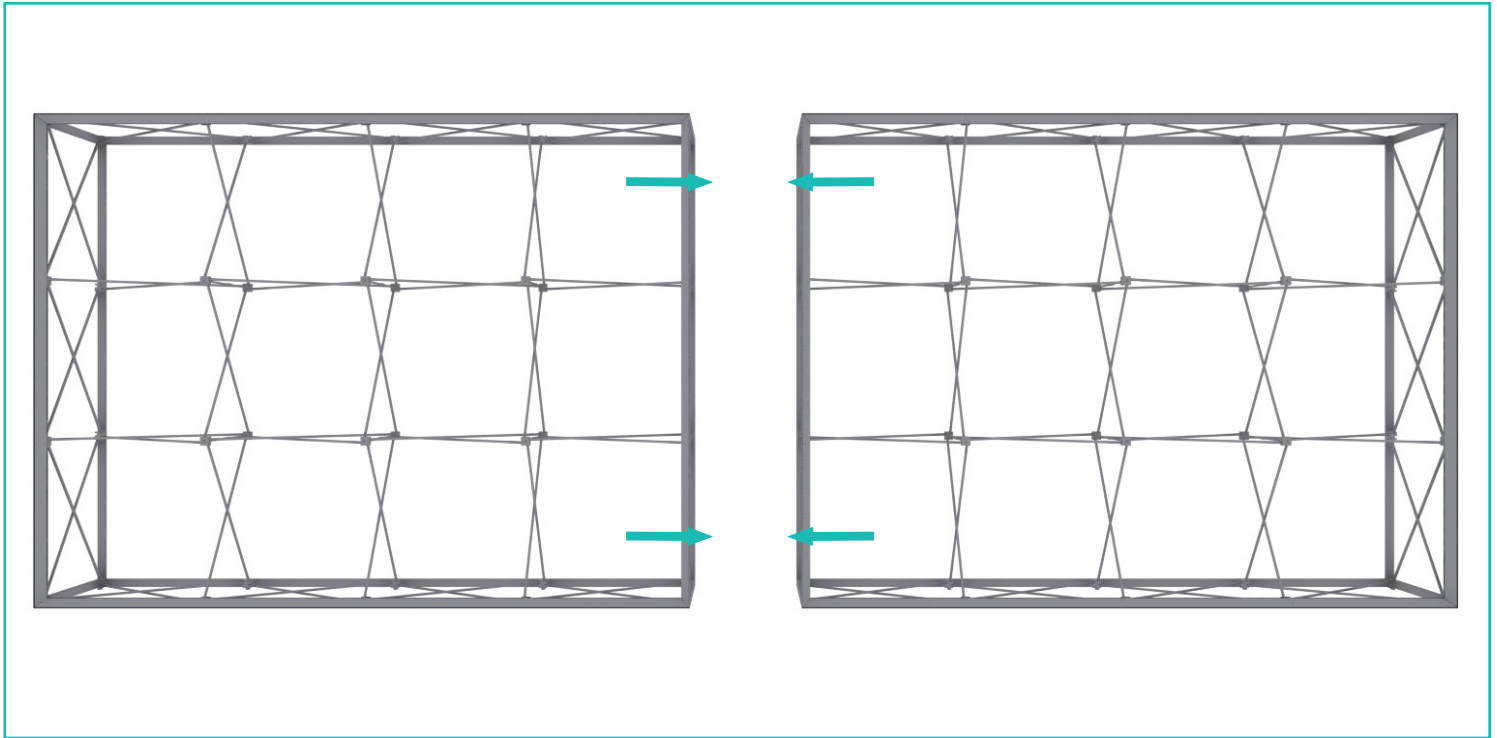

Place the (2) 4x3 frames side by side.

Note: Rendering shown without graphics for clarity.

Straight Connection



1
*Starting from behind, make sure the frames are flushed next to each other.

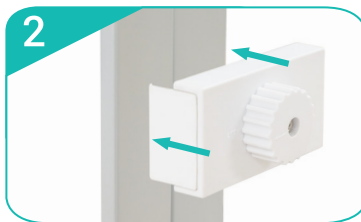

2
Slide Straight Connector onto the channel bars of both frames.

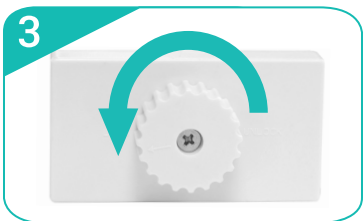

3
Turn dial to the left to lock the Straight Connector in place. Repeat for each vertical sections (6 total).

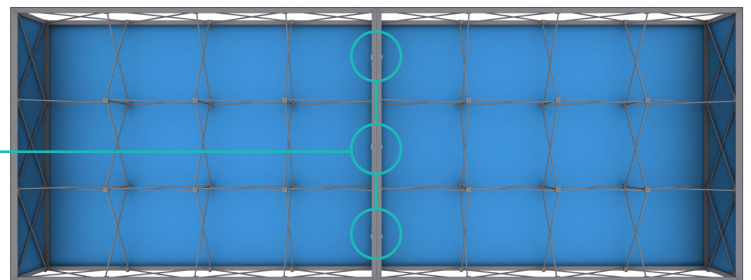

*Back side of the 4x3's shown above.